

A photograph of a modern building with a curved, glass facade and a large, overhanging roof structure. The building is surrounded by other skyscrapers in a city setting. The text "BAHAN-BAHAN STRUKTUR" is overlaid in red on a semi-transparent grey background at the bottom of the image.

# BAHAN-BAHAN STRUKTUR

# Tugas-3

Study Kasus Bangunan sesuai dengan Bahan Konstruksi yang digunakan.

1. Bahan Baja ( No Absen 1-10)
2. Bahan Beton (No Absen 11-20)
3. Bahan Kayu (No Absen 21-30)

Setiap mahasiswa mencari obyek kasus berupa bangunan yang sudah ada yang menggunakan bahan konstruksi sesuai pembagian kelompok diatas.

Buat gambar denah, potongan dan detail strukturnya (detail sambungan/pertemuan antara kolom, balok dan plat, detail bubungan kuda-kuda atap, dll)

Deskripsikan berdasarkan gambar diatas sistem struktur atas dan struktur atap yang ada pada bangunan tsb

.  
Dikumpulkan Tgl. 01 Oktober 2021 Jam 23.00.

Dipresentasikan Tgl. 02 Oktober 2021 Jam 10.00 – 12.30 (jam kuliah).















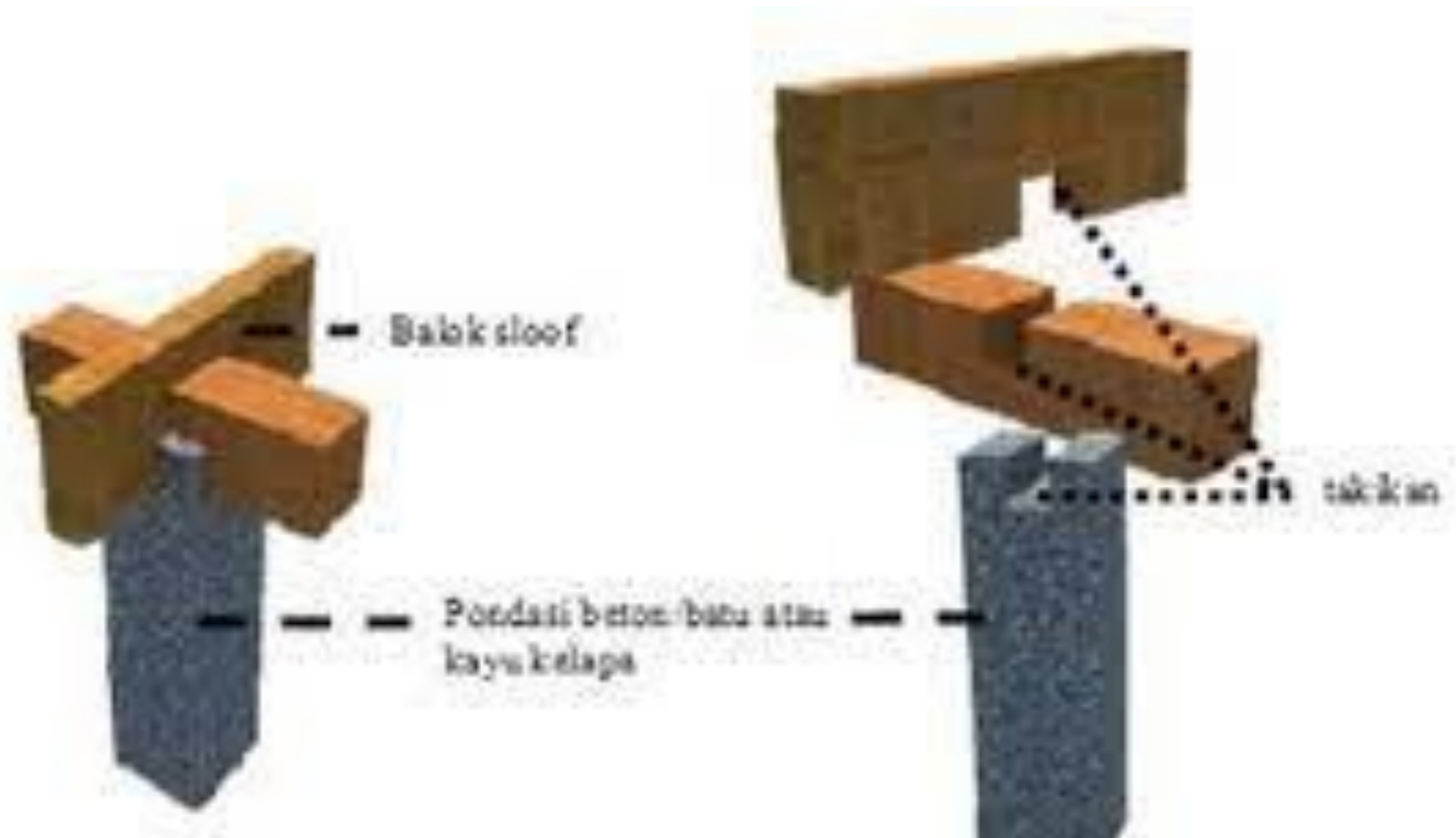

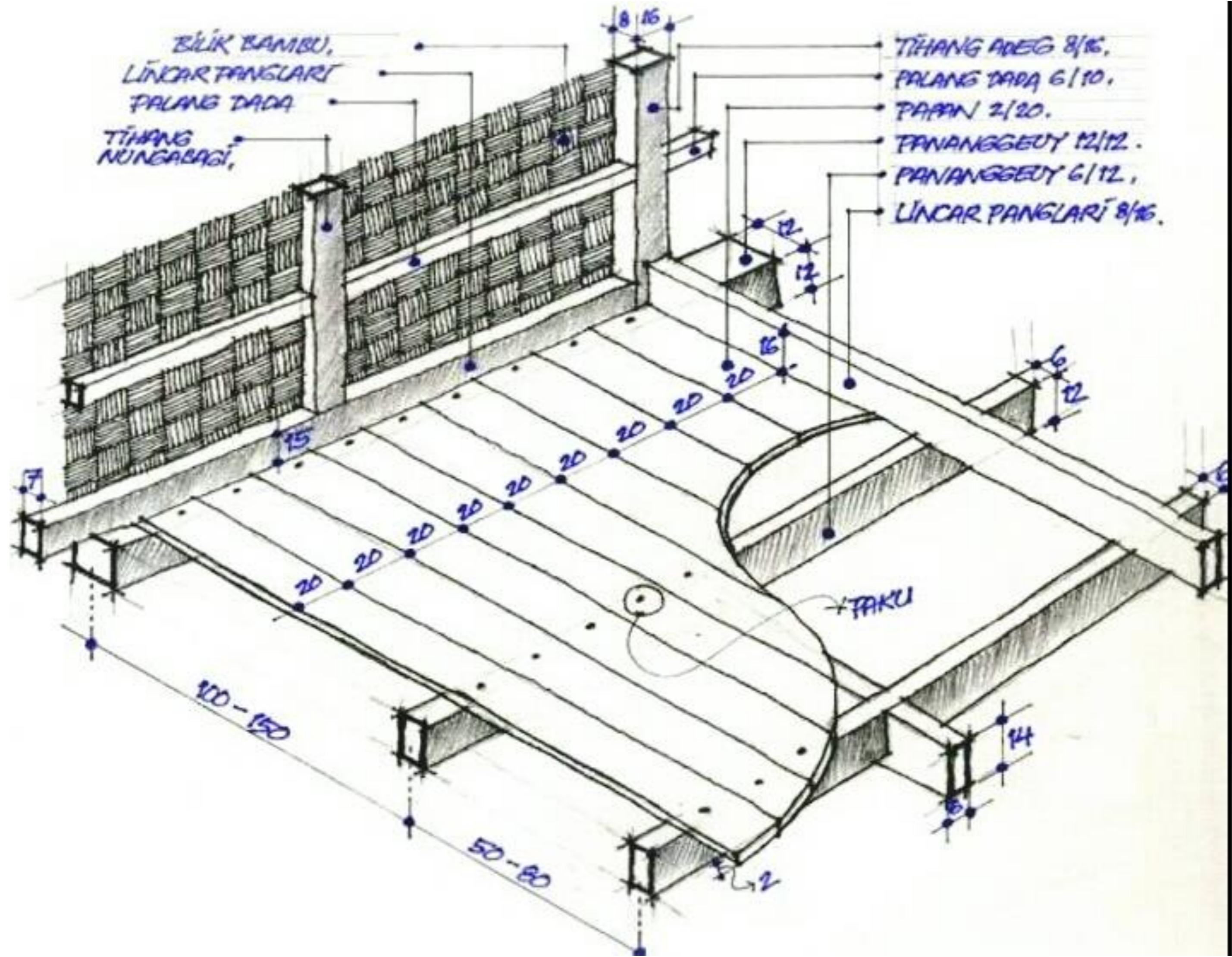

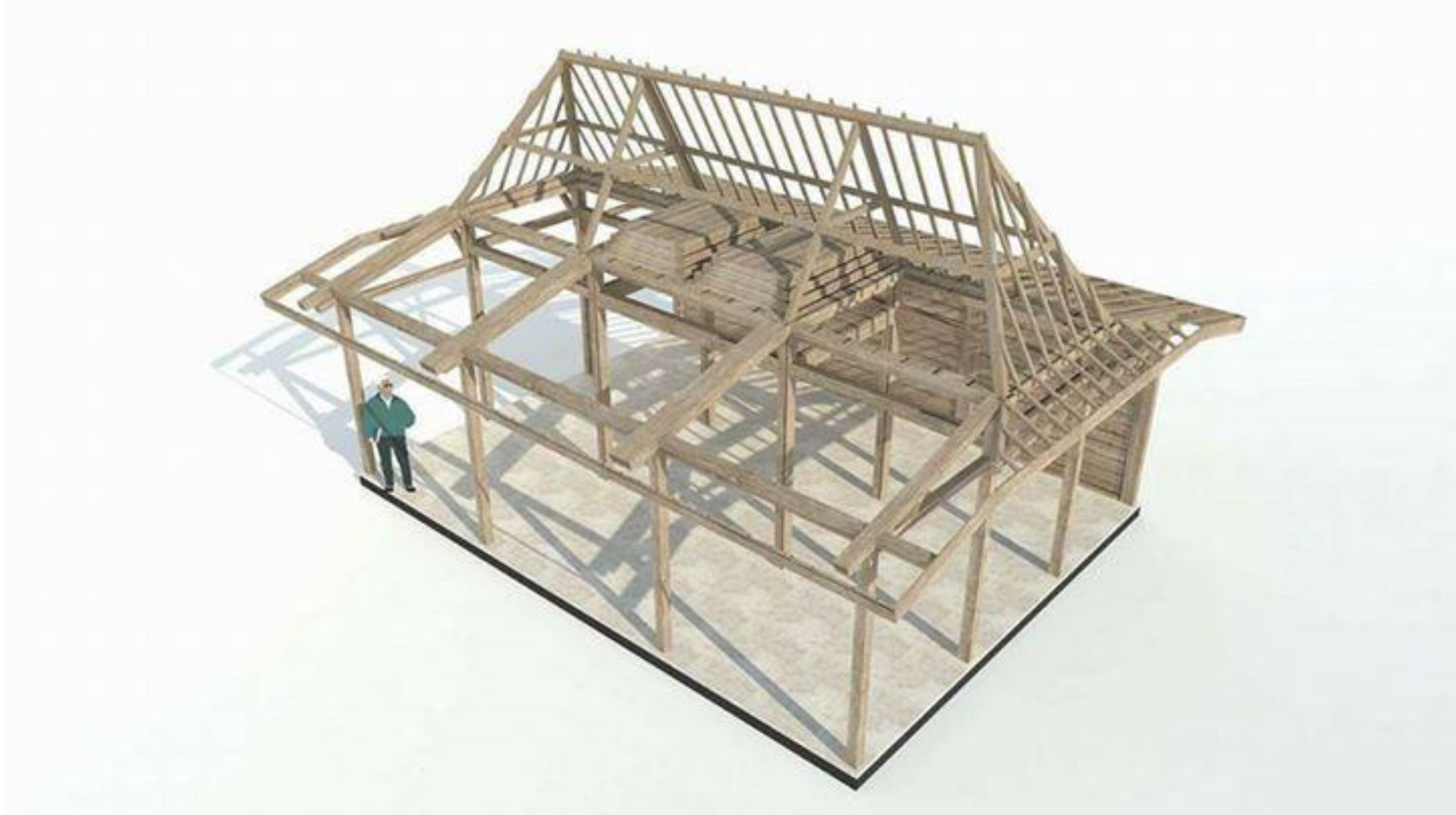

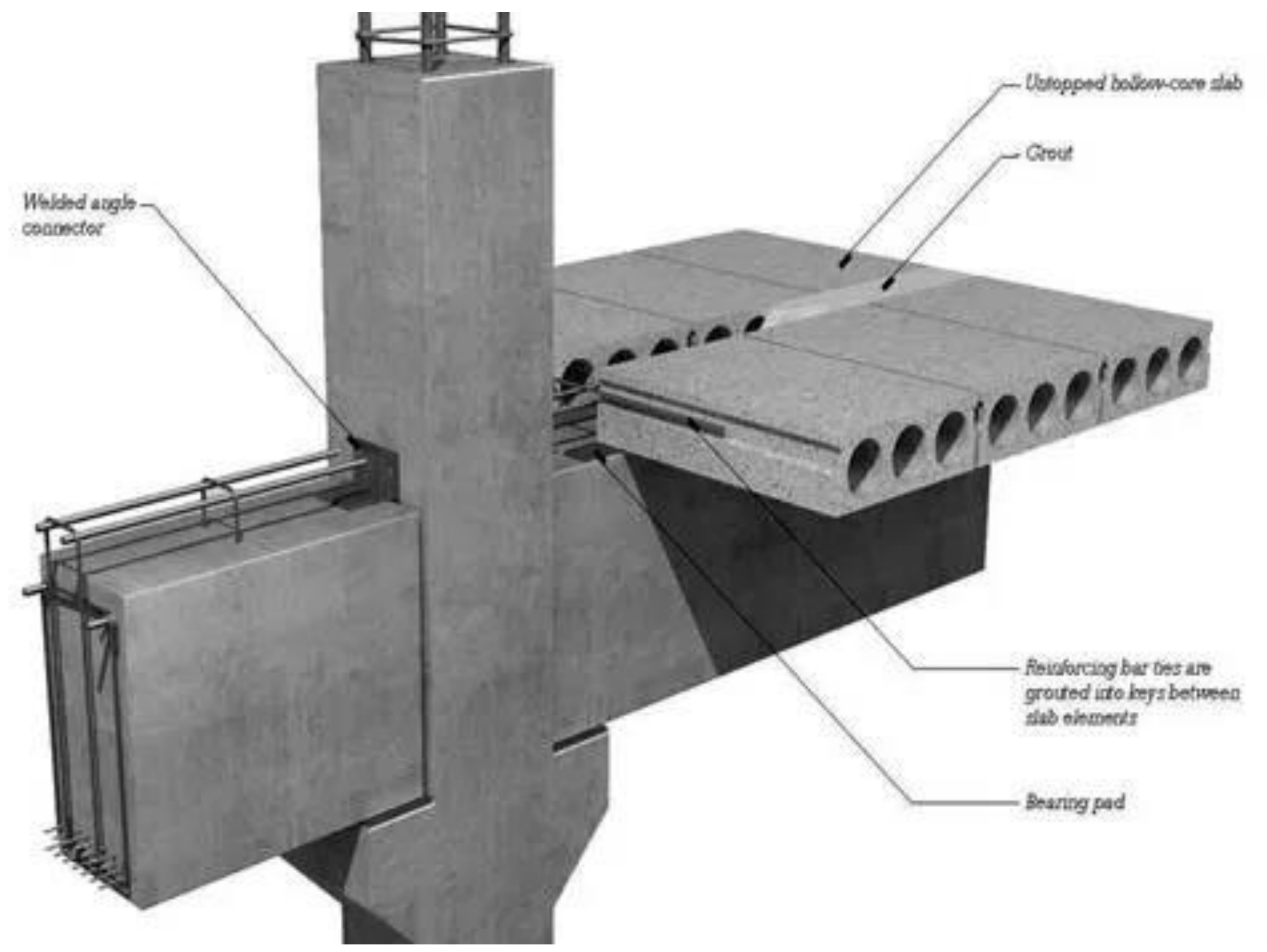
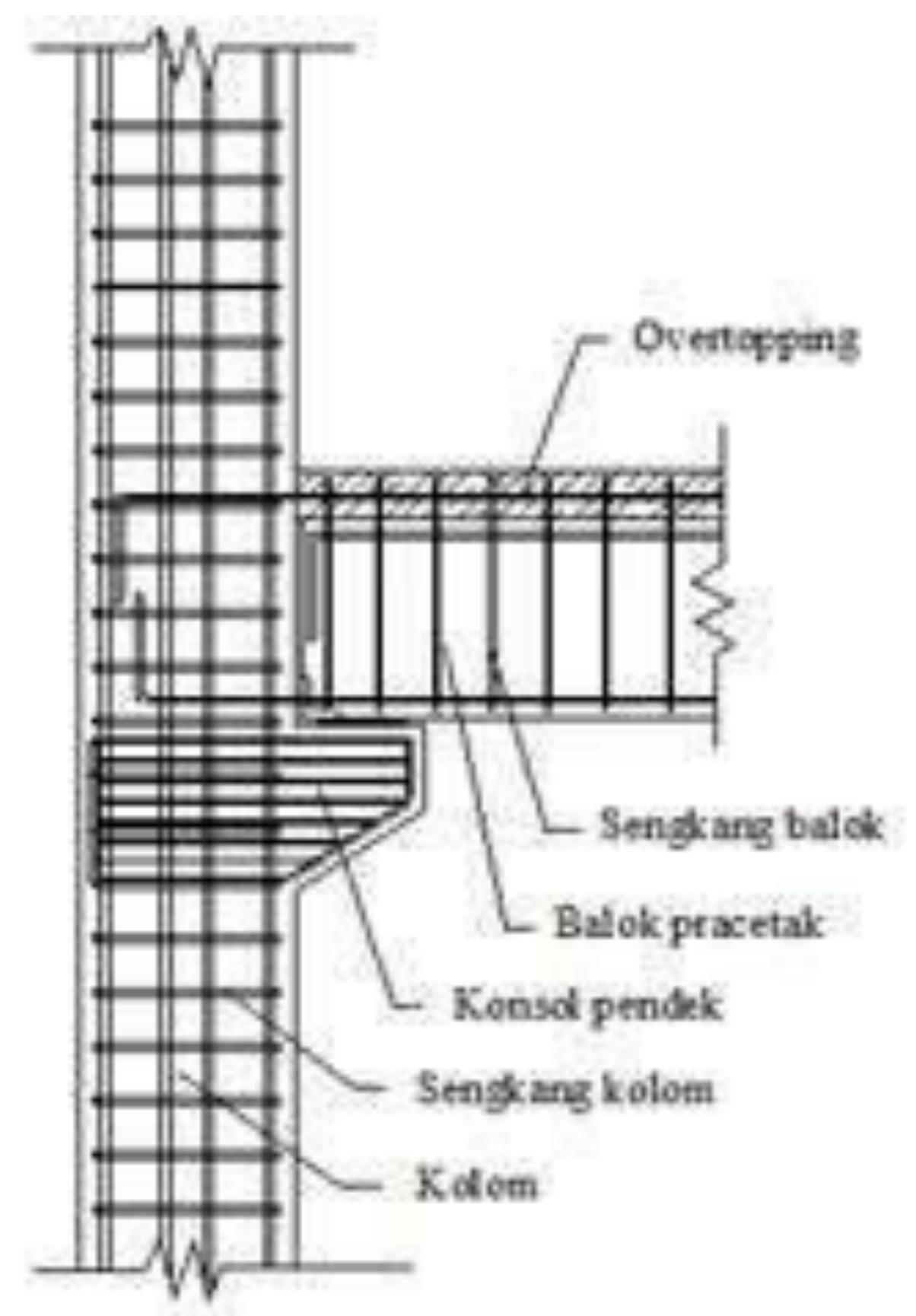

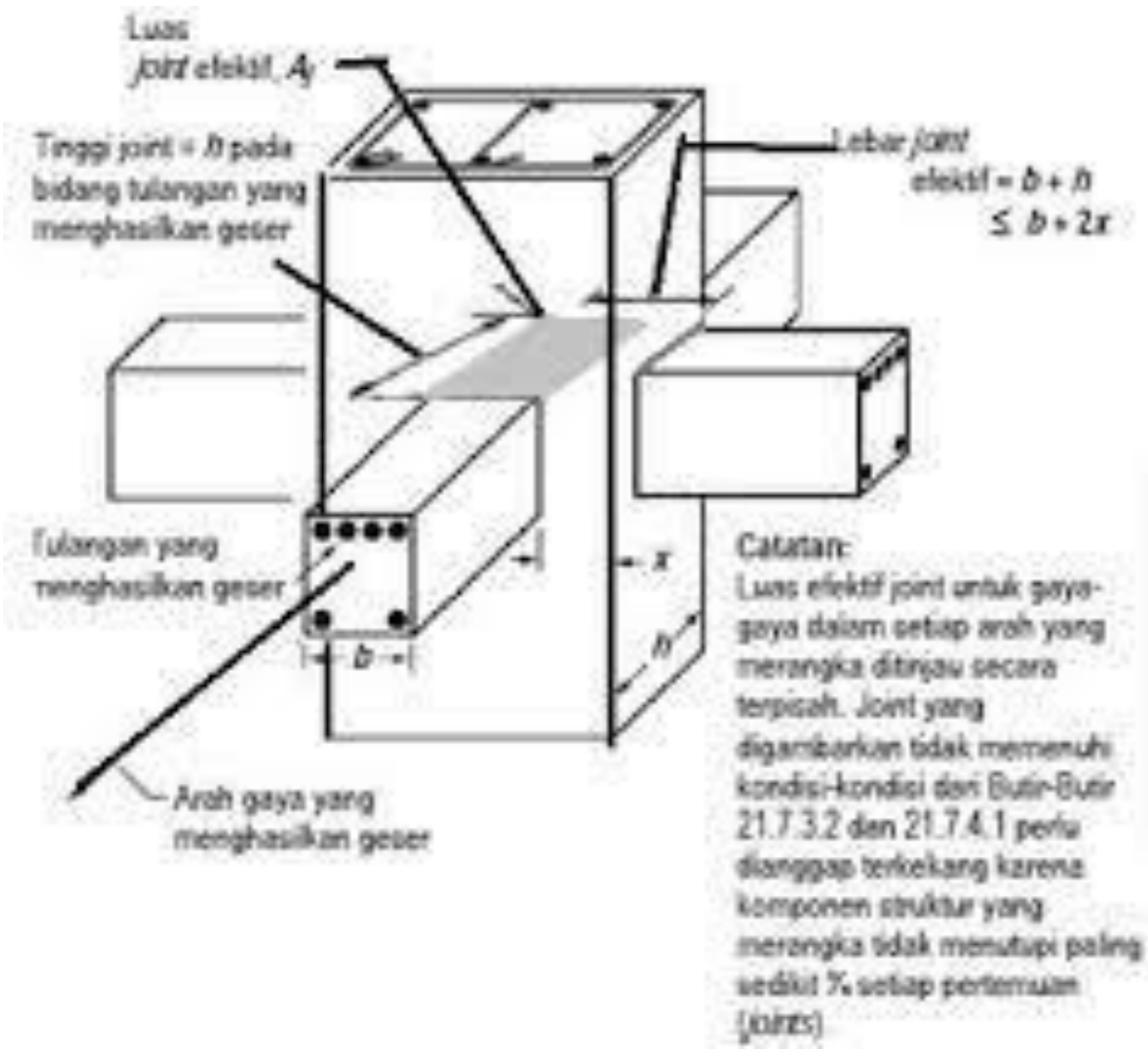

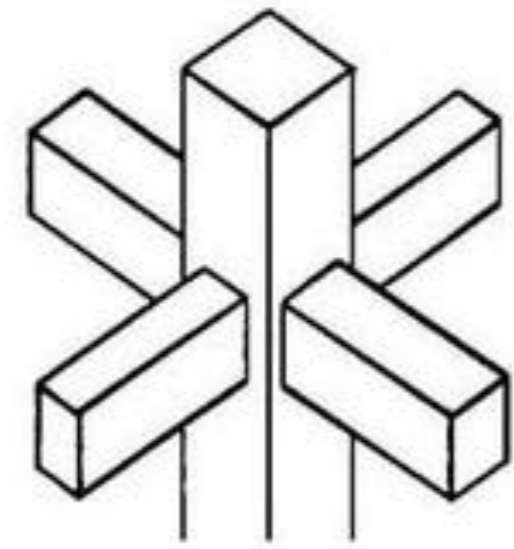

a) Interior  
A.1

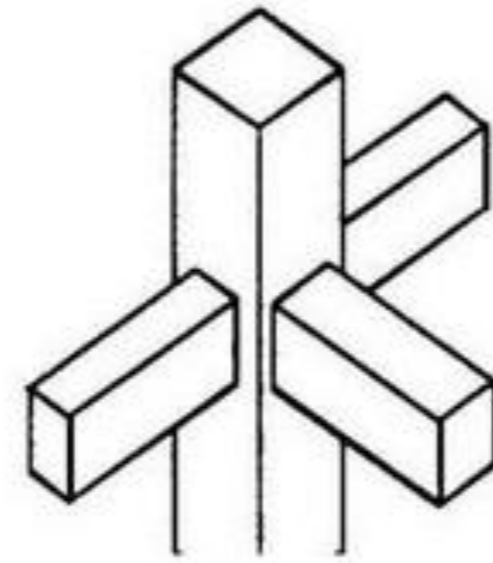

b) Exterior  
A.2

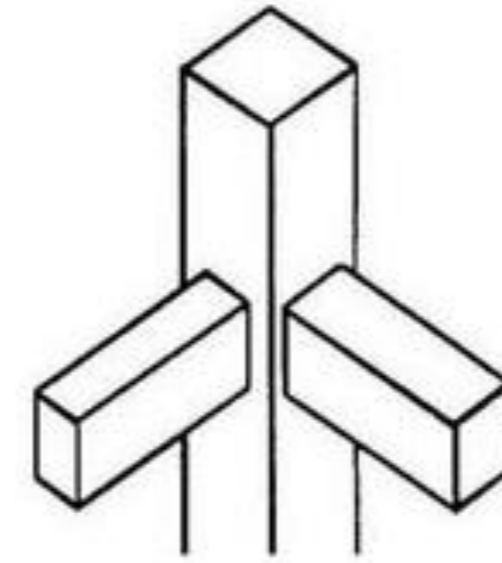

c) Corner  
A.3

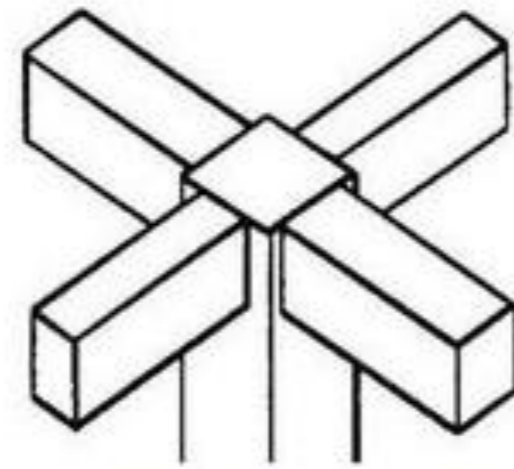

d) Roof  
Interior B.1

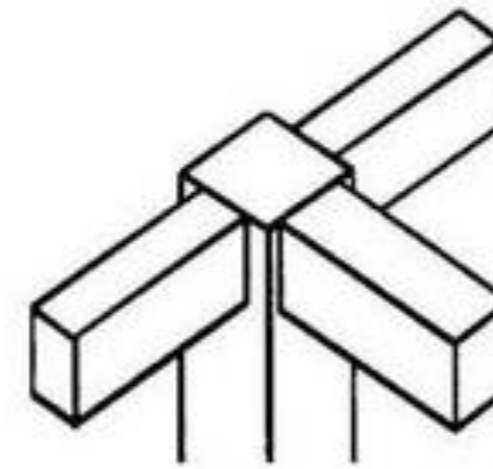

e) Roof  
Exterior B.2

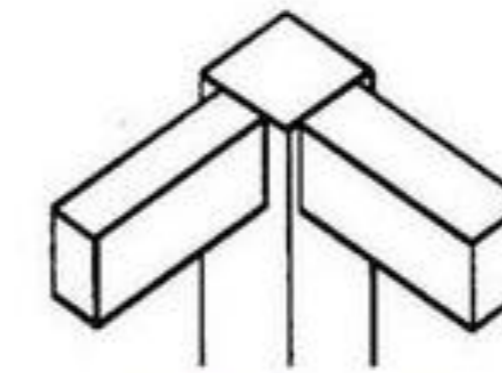

f) Roof  
Corner B.3